

Bolt Module to Floor

1 Using provided dimensions, layout and drill (4) holes to secure the Module to the floor.

The hole size in Module is sized for clearance of 1/2 -13 bolts.

- ⓘ Be sure to consult the local building codes to ensure proper anchor hole size and anchor specifications that are to be used. Follow local building code for proper bolt, washer and lock washer specifications.

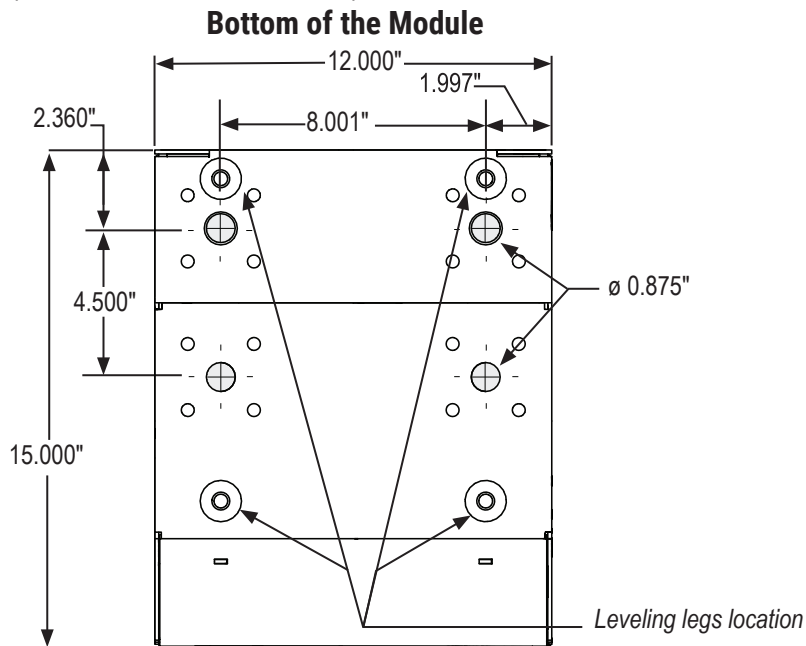

2 After holes are drilled and anchors are inserted (per local building code specifications) secure enclosure to anchors by using:

- (4) 1/2 -13 bolts
- (4) 1/2 lock washers
- (4) 1/2 washer

- ⓘ Make sure to use hardware that meet local building specifications.

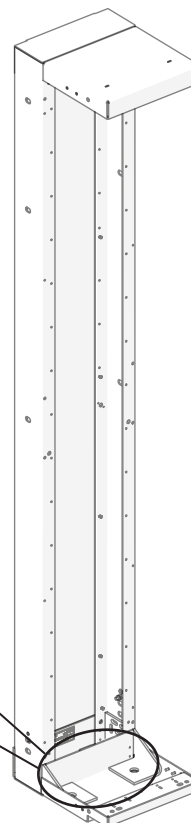
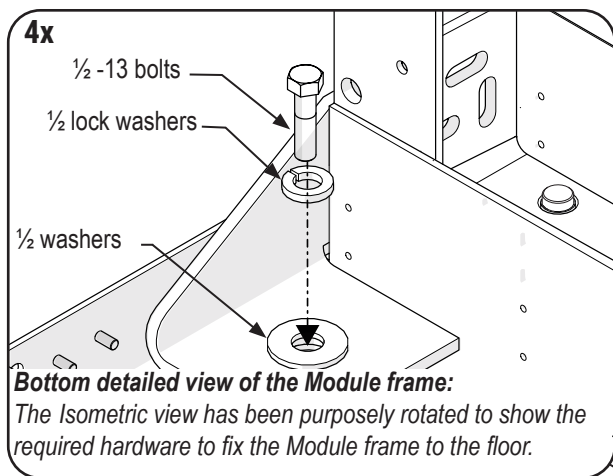

Leveling Module Legs

- 1 "Break loose" the jam nut and rotate away from the bottom of the Module.
To lower the Module, rotate the leveling leg counter-clockwise.
To raise the Module, rotate the leveling leg clockwise.
- 2 Repeat for each leveling leg as needed. Once the Module has been leveled/raised/lowered to the desired height, tighten the jam nut up against the bottom of the cabinet.

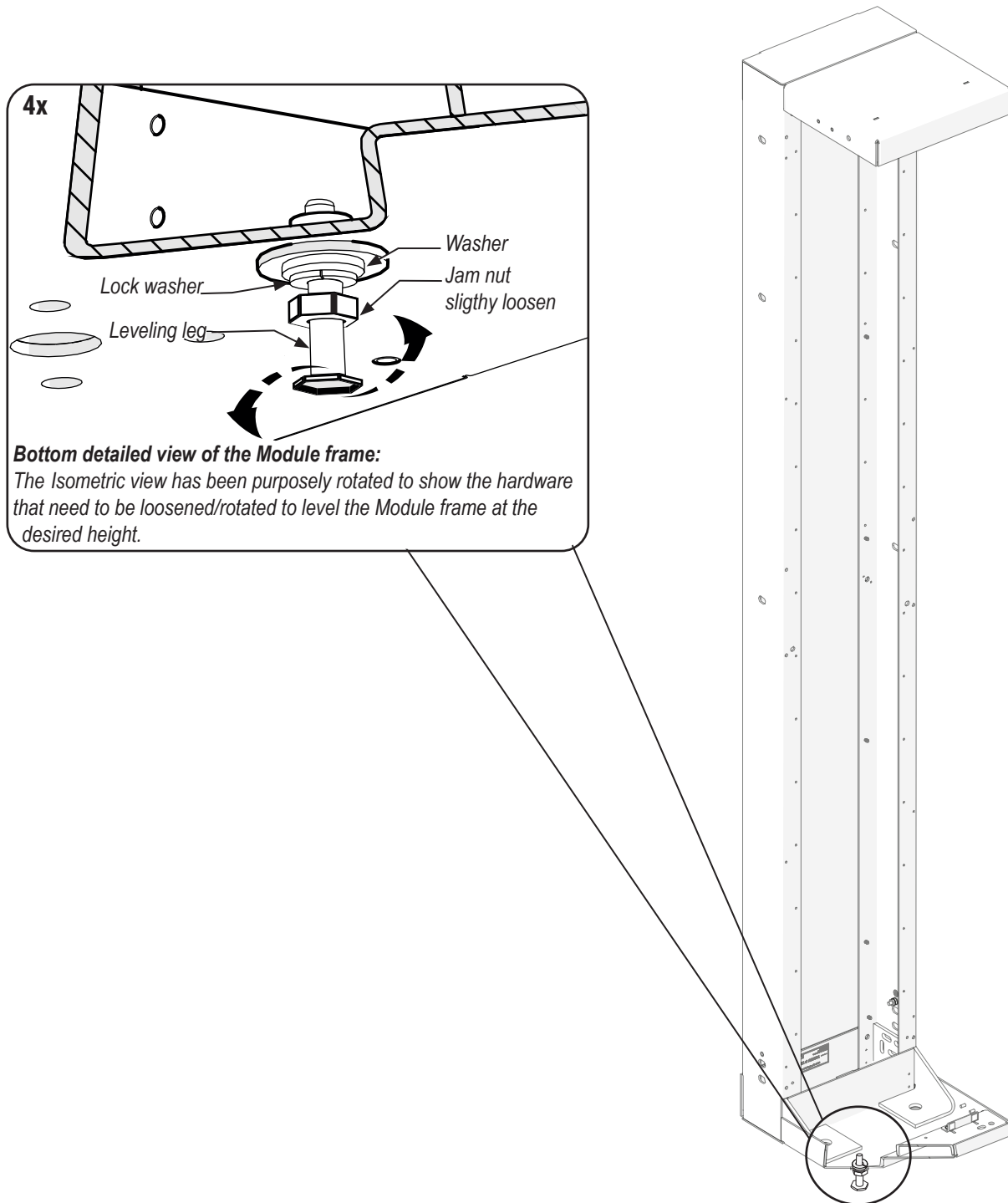

Bolt Module Side-to-Side

- 1 Place the Module Side-to-Side in one of the adjoined Cabinets by making sure that the side ganging holes/slots are aligned (it is assumed that at this point the Module have been placed in position and leveled).
Using the provided hardware kit (**DCX-GANG-KIT01**), place one 5/16 -18 bolt and tooth washer.
Repeat this process through the remaining (5) holes on the perimeter of the Module.
- 2 On the opposite side (of the Cabinet), attach one 5/16 tooth washer and nut to the protruding bolts.
Repeat this process for the (5) remaining bolts and tighten down the nuts, by drawing the Cabinet and Module flush together.
Repeat this process for all Side-to-Side Cabinets that require the installation of the Module.

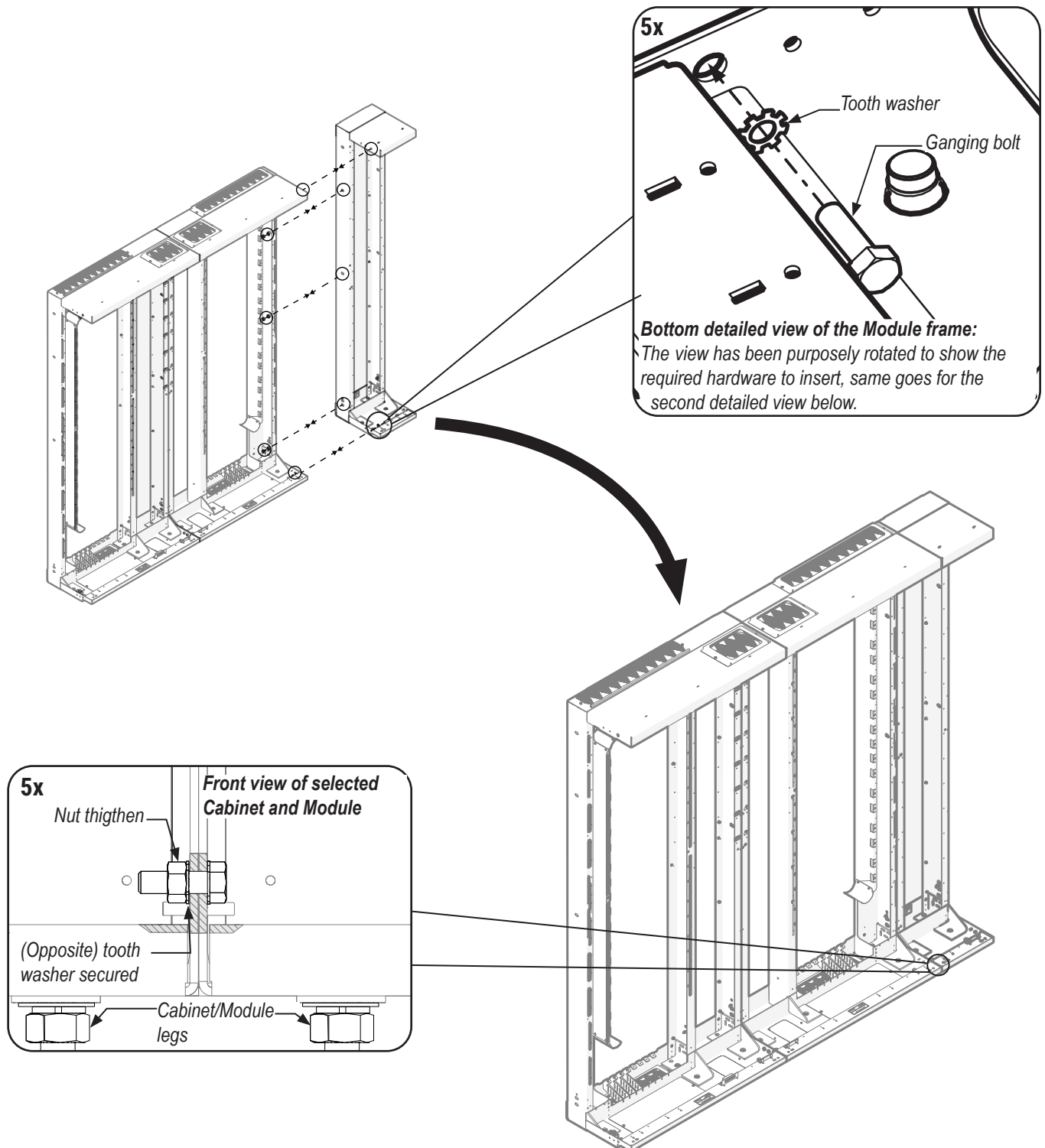

Bolt Module Back-to-Back

1 Place Module Back-to-Back by making sure that the rear ganging holes are aligned (it is assumed that at this point the Modules have been placed in position and leveled).

Using the provided hardware kit (**DCX-GANG-KIT01**), place one 5/16 -18 bolt and tooth washer through one of the adjoining Modules.

Repeat this process through the remaining (5) holes on the perimeter of the Module.

2 On the opposite Module, attach one 5/16 tooth washer and nut to the protruding bolts.

Repeat this process for the (5) remaining bolts and tighten down the nuts, by drawing the two Modules flush together.

Repeat this process for the (2) rows of Cabinets placed Back-to-Back that require the installation of the Modules (see page 8).

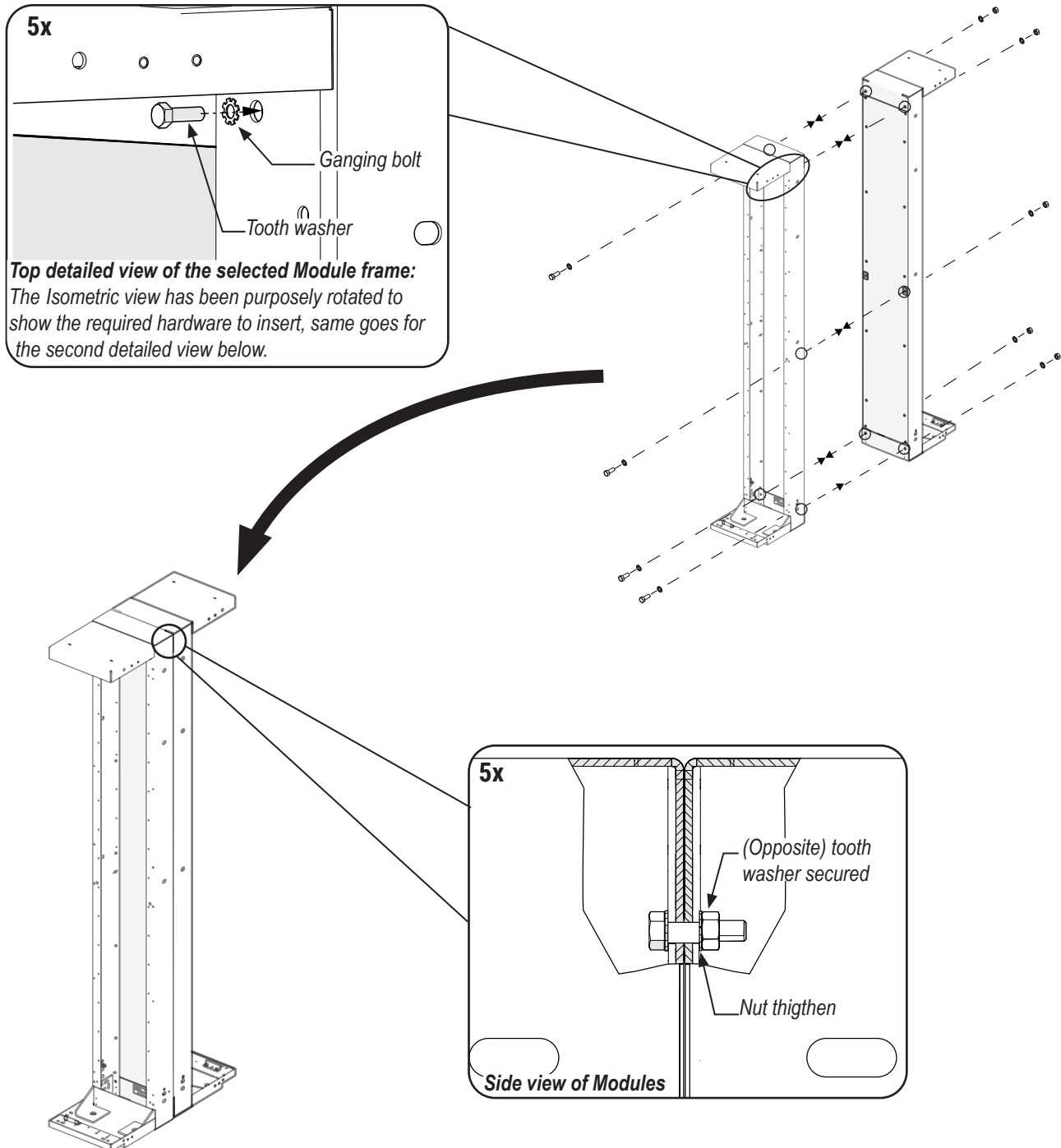

Installation of Inner Channel

- 1 Align the pins of the Inner Channel to their respective positions.
Insert the Inner Channel and use the (2) screws provided to secure it to the Module.

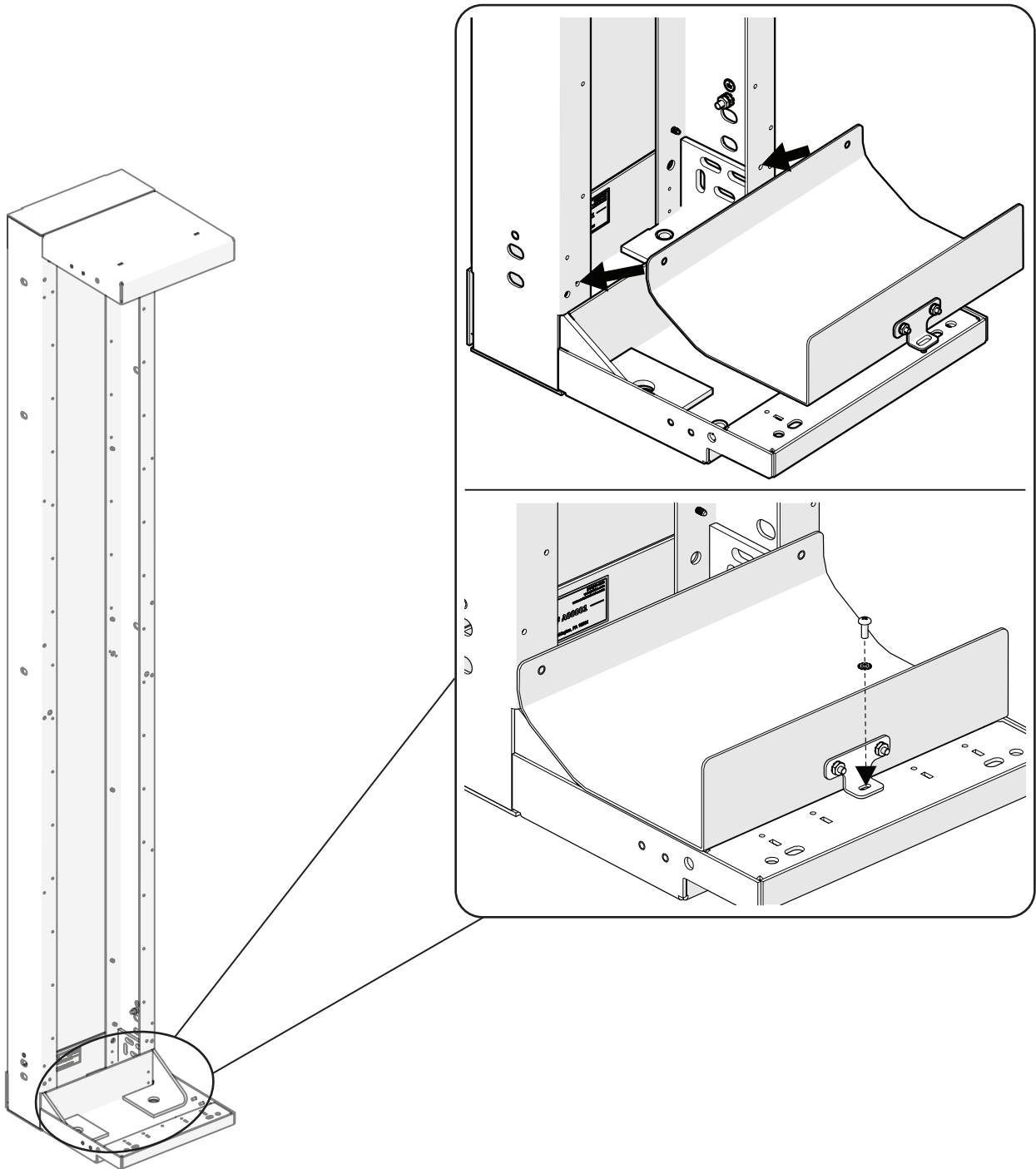

Installation of Slack Spools

- 1 Slide the Patch Cord Slack Spool into the Bracket and make sure the holes/slots of the Spool and bracket are aligned. Secure the Patch Cord Slack Spool with the zinc finish screws, for plastic material, and tighten them to complete the assembly.

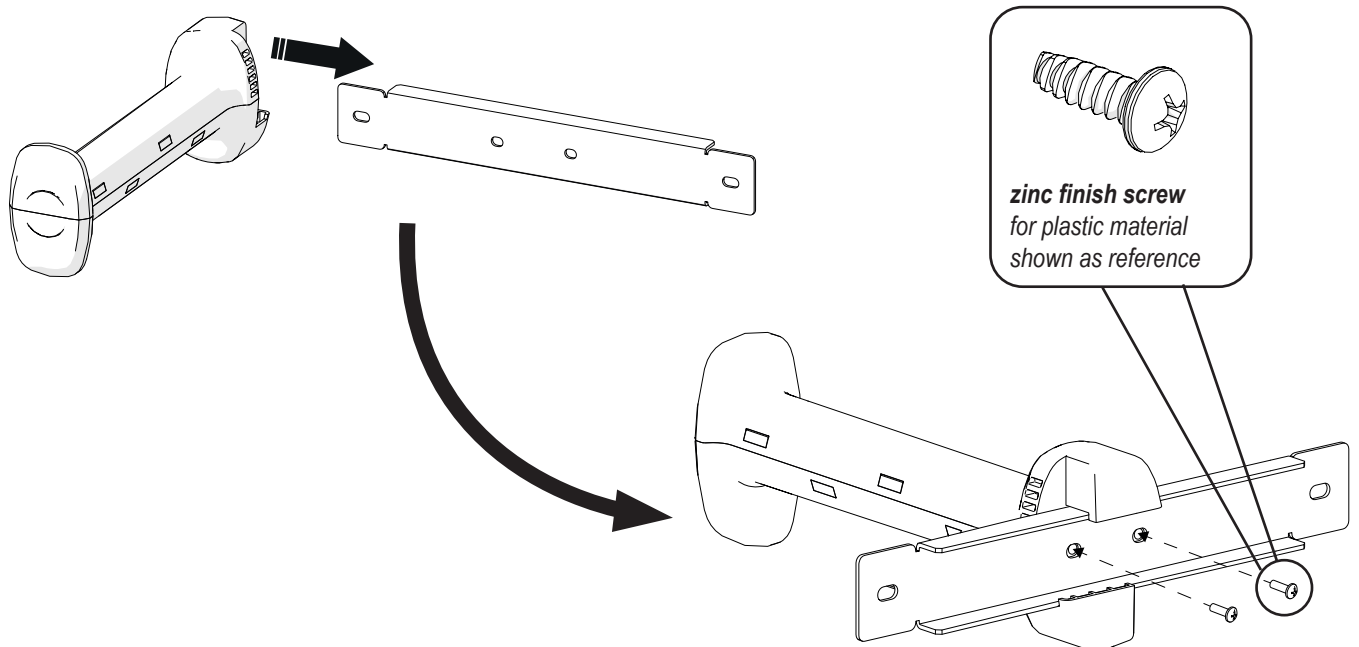

- 2 Once the Slack Spool assembly completed, use the thread cutting screws with black finish to secure the assembly to the Module. Repeat this process for the remaining Slack Spools assemblies (15).

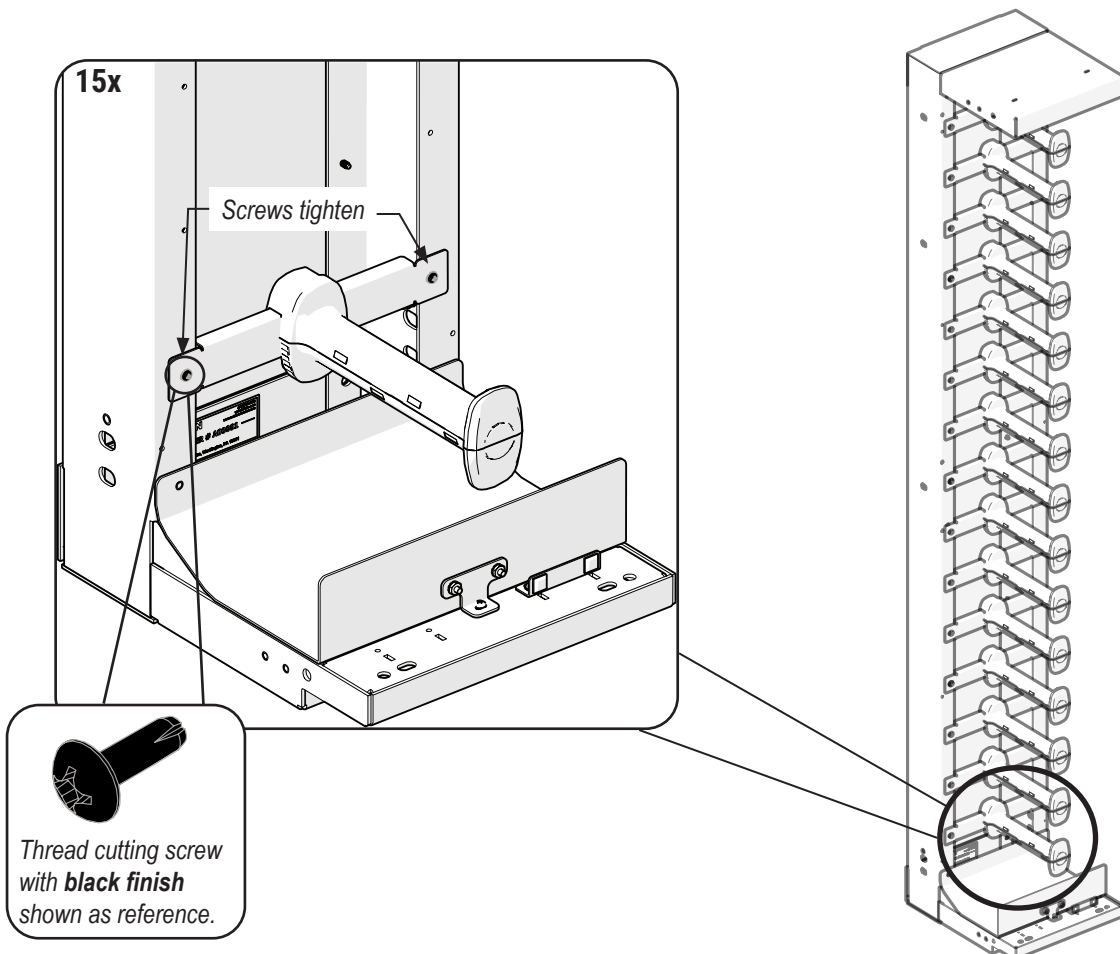

Door removal (optional)

i The door removal could facilitate the positioning of the slack fibers in the Module (see the next page).

1 Begin by opening the Module door.

Once the door is opened, on the top hinge assembly, press the latch to disengage the door from the Module.
Tilt the door downwards and lift it from the Module.

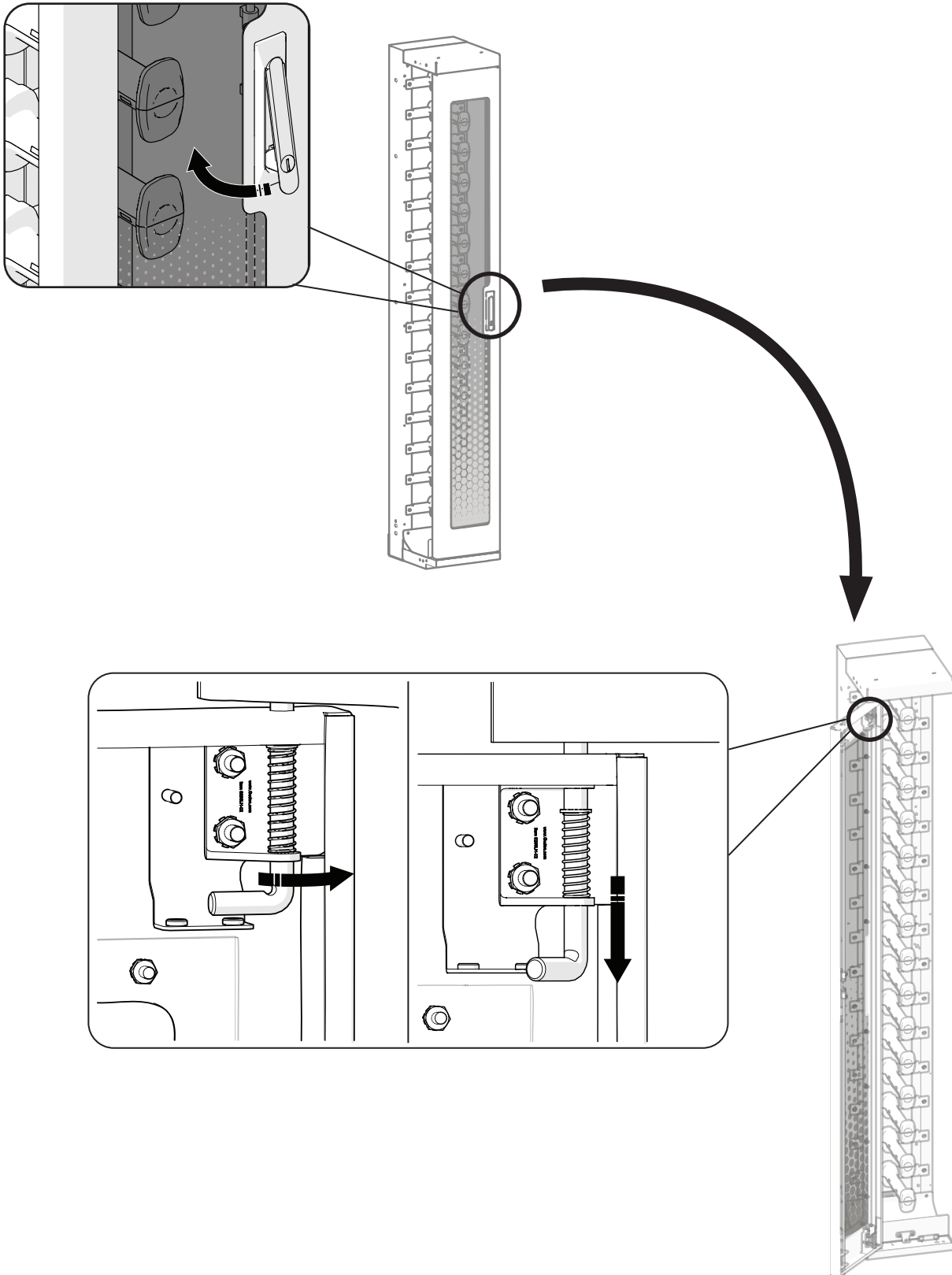

Routing Patch Cord fibers in a Cross-Connect system

i The grey/white arrows in the illustrative images below represents a connecting path which interconnects Cabinets in different rows.

Front Side

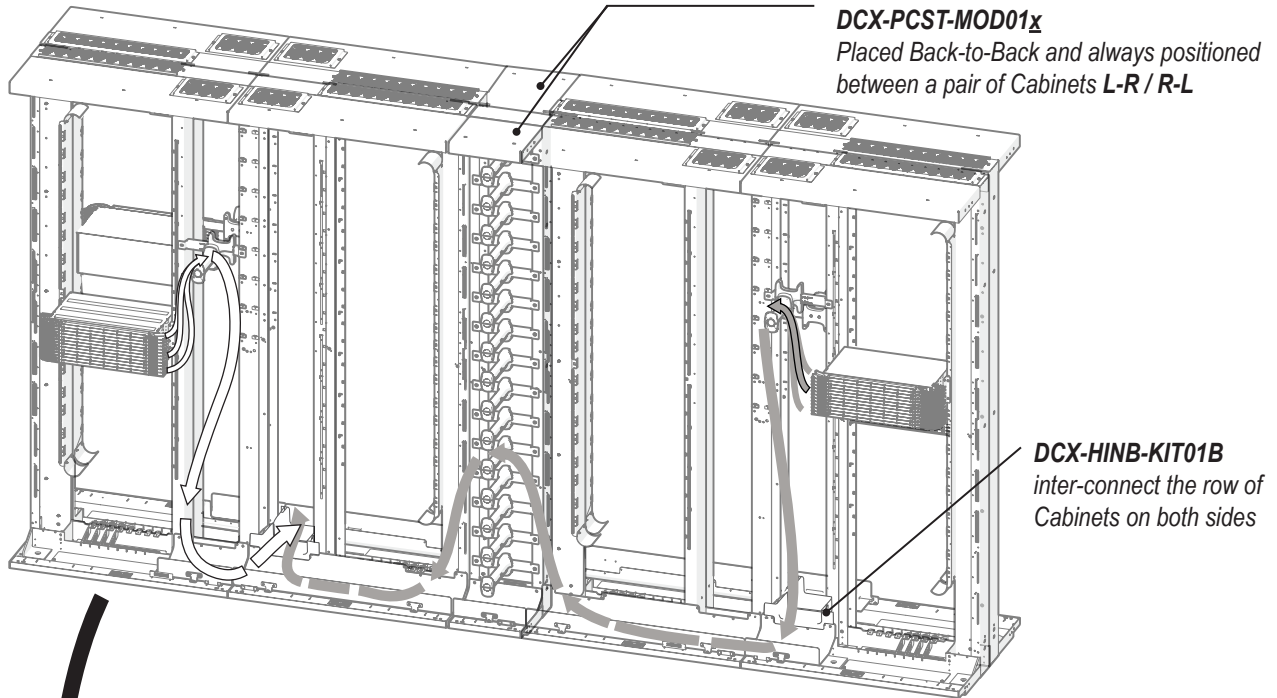

Back side

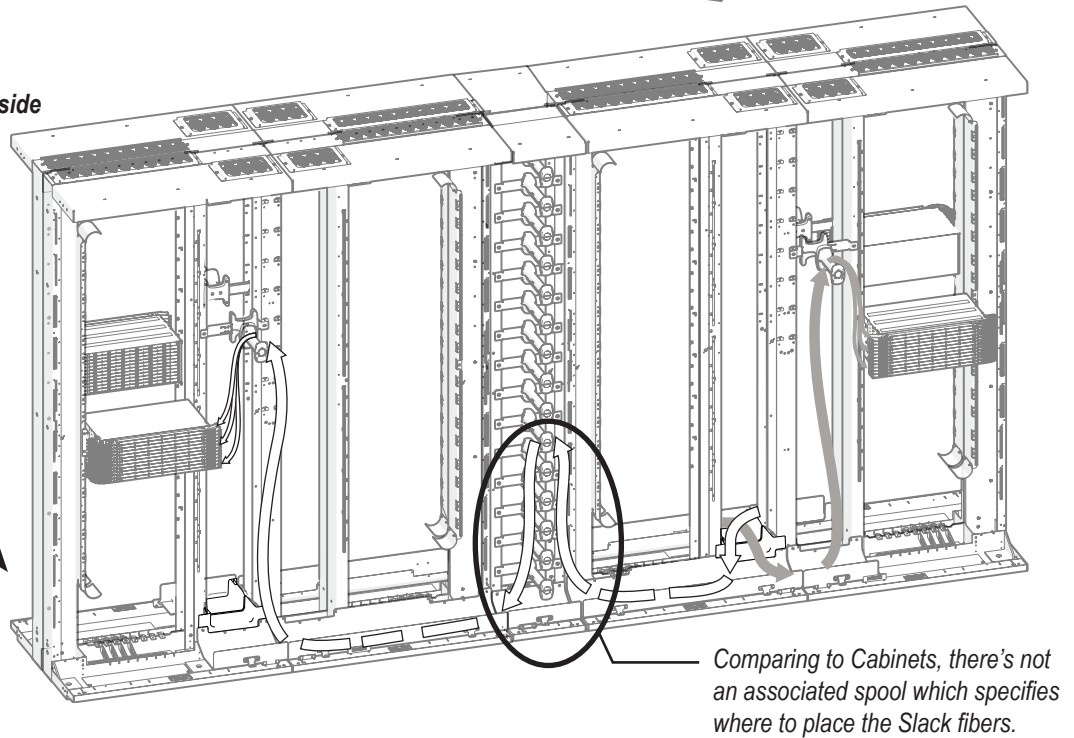

DCX XConnect Patch Cord Slack Module - Quick Start Guide

PX106869 - EN REV B

This document is also available at our microsite:

www.belden.com/dcx

For more information about BELDEN Technical support, call:

1-800-BELDEN-1

Scan this QR code to
access more technical
information of our
products and get
constant updates



BELDEN